

TYPE: AKS2020

ANSI Kleinschieber 1/2 – 2" Class1500

ANSI Gate Valve 1/2 – 2" Class1500

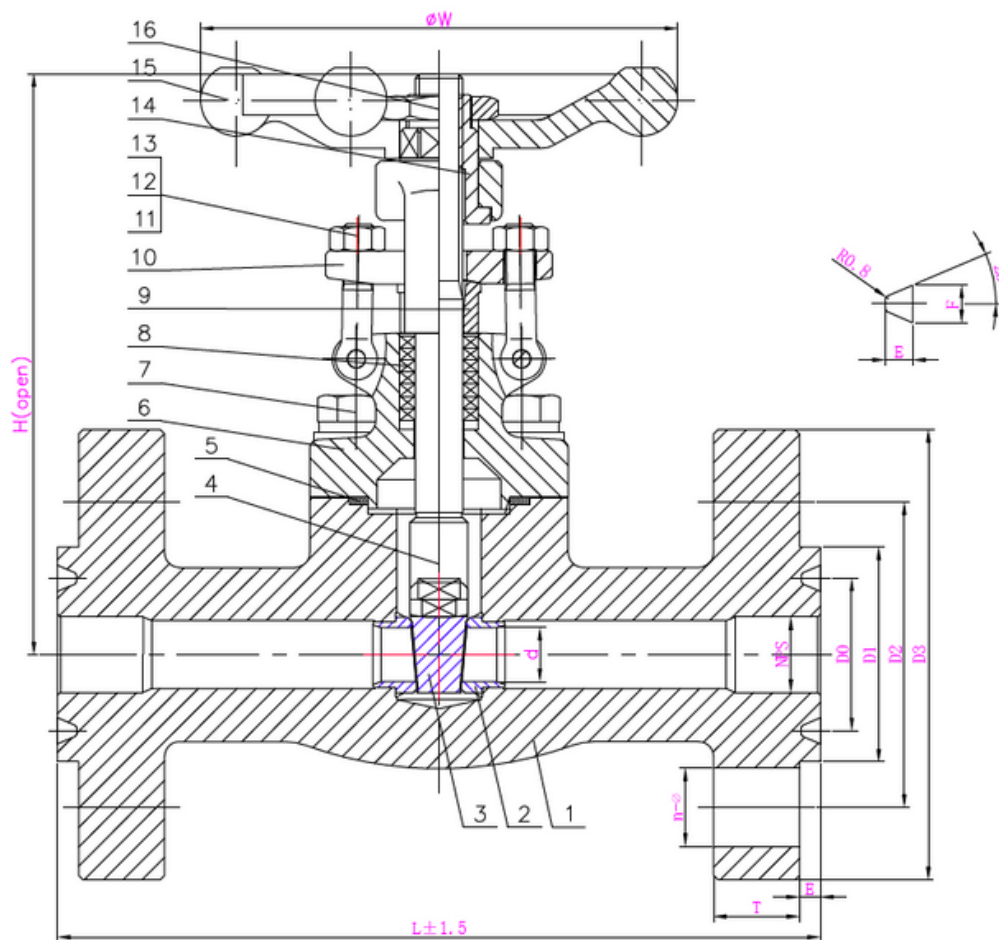

Technical Specification:

1. Design and machining API 602
2. Inspection and test API 598
3. Face to Face ASME B16.10
4. Dimension of connection end flange ASME B16.5

DRW Industrietechnik GmbH

Bodenschwinger Str. 125

D-44357 Dortmund

Telefon: +49 2 31 - 92 71 44-0

info@drw-armaturen.de

www.drw-armaturen.de



Abmessungen / Dimensions:

SIZE	L	W	H (open)	d	D0	D1	D2	D3	T	E	F	n-ø
1/2"	216	100	162	10.0	39.67	60.5	82.6	120	22.3	6.35	8.74	4-22
3/4"	229	125	196	13.5	44.45	66.5	88.9	130	25.4	6-35	8.74	4-22
1"	254	160	223	18.0	50.80	71.5	101.6	150	28.6	6.35	8.74	4-26
1-1/4"	279	160	249	23.0	60.33	81.0	111.1	160	28.6	6.35	8.74	4-26
1-1/2"	305	180	285	28.5	68.27	92.0	123.8	180	31.8	6.35	8.74	4-30
2"	371	220	355	36.0	95.25	124.0	165.1	215	38.1	7.92	11.91	8-26

Materialien / Materials:

No.	Part Name	Material
1	Body	ASTM A105
2	Seat	13Cr+STL
3	Disc	13Cr
4	Stem	13Cr
5	Gasket	SS304+Graphite
6	Bonnet	ASTM A105
7	Bolt	A193 B7
8	Packing	Graphite
9	Gland	13Cr
10	Gland Flange	ASTM A105
11	Bolt	A193 B7
12	Nut	A194 2H
13	Pin	1025
14	Stem Nut	1Cr13
15	Hand Wheel	A197
16	H.W Lock Nut	Carbon Steel

DRW Industrietechnik GmbH

Bodenschwinger Str. 125

D-44357 Dortmund

Telefon: +49 2 31 - 92 71 44-0

info@drw-armaturen.de

www.drw-armaturen.de

