

## TYPE: ARK1721

Rückschlagklappe 2"- 3" Class600

Swing Check Valve 2"- 3" Class600

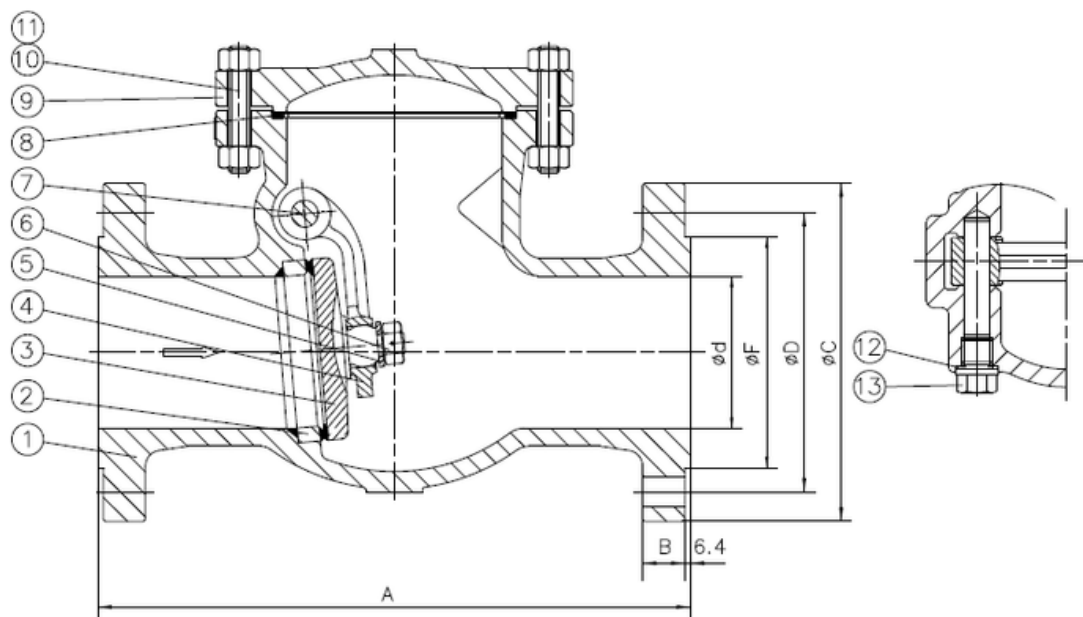

### Technical Specification:

1. Design and machining BS 1868
2. Inspection and test acc. API 598
3. Face to Face acc. ASME B16.10
4. Dimension of connection end flange acc. ASME B16.5

### **DRW Industrietechnik GmbH**

Bodenschwinger Str. 125

D-44357 Dortmund

Telefon: +49 2 31 - 92 71 44-0

info@drw-armaturen.de

[www.drw-armaturen.de](http://www.drw-armaturen.de)



## Abmessungen / Dimensions:

SIZE	d	A	B	C	D	n	E	F
2"	50.8	292	26	165	127	8	19	92
2.5"	64	330	29	190	149	8	22	105
3"	76.2	356	32	210	168	8	22	127

## Materialien / Materials:

No.	Part Name	Material
1	Body	ASTM A216-WCB
2	Seat Ring	ASTM A105+STL
3	Disc	ASTM A105+Cr13
4	Arm	ASTM A216-WCB
5	Disc Washer	ASTM A276-410
6	Disc Nut	ASTM A276-410
7	Hinge Pin	ASTM A182-F6a
8	Cover Gasket	SS304+Graphite
9	Cover	ASTM A216-WCB
10	Cover Studs	ASTM A193-B7
11	Cover Nuts	ASTM A194-2H
12	Plug Gasket	SS304+Graphite
13	Plug	ASTM A29-1035

### **DRW Industrietechnik GmbH**

Bodenschwinger Str. 125

D-44357 Dortmund

Telefon: +49 2 31 - 92 71 44-0

info@drw-armaturen.de

[www.drw-armaturen.de](http://www.drw-armaturen.de)

